

ASSEMBLY INSTRUCTIONS



FP2 Console Assembly

(507) 287-3535 www.emcorenclosures.com

ITEM	DESCRIPTION	PART No.
1	10-24 SHOULDER SCREW	451471
2	1/4-20 X .50 BUTTON HEAD SCREW	449128
3	10A X .62 WOOD SCREW	940011
4	ANGLE, SUPPORT	450894

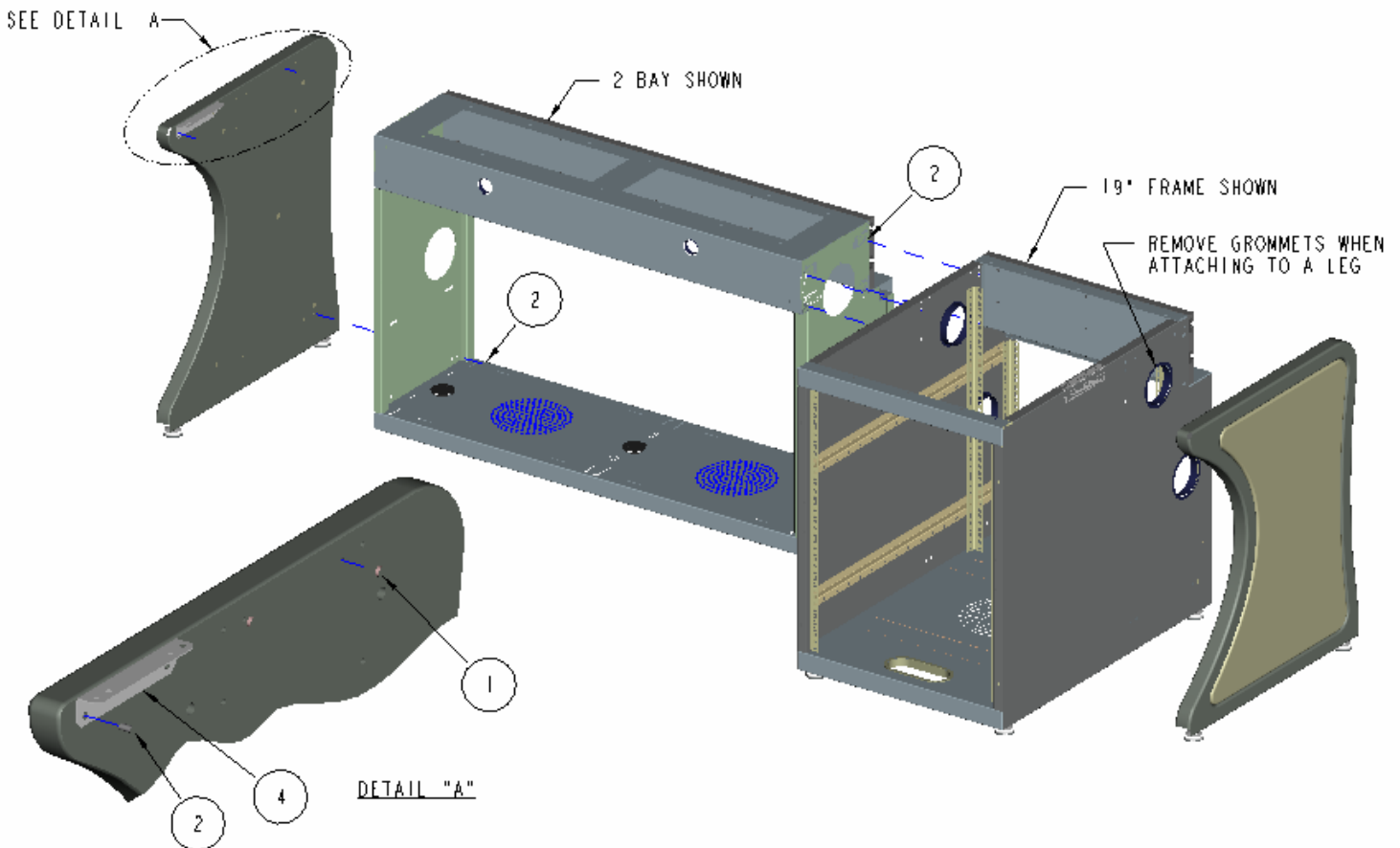

CONSOLE BASE ASSEMBLY

- 1) Remove doors and panels from bays and set aside.
- 2) Install 10-24 shoulder screws (item 1, detail "A") into legs and frames. Shoulder screws are used to locate the bays only. No shoulder screw required for leg to frame assembly.
- 3) Hang bays onto legs and frames by placing the "doghouse" cutouts provided on each end of the bays over the shoulder bolts.
- 4) Install 1/4-20 button head screws (item 2) to join legs, bays & frames. Six screws required when joining bays to legs and frames. Four required when joining frames to legs.
- 5) Install "angle supports" onto legs (item 4) with 1/4-20 screws (item 2).

FP2 Console Assembly

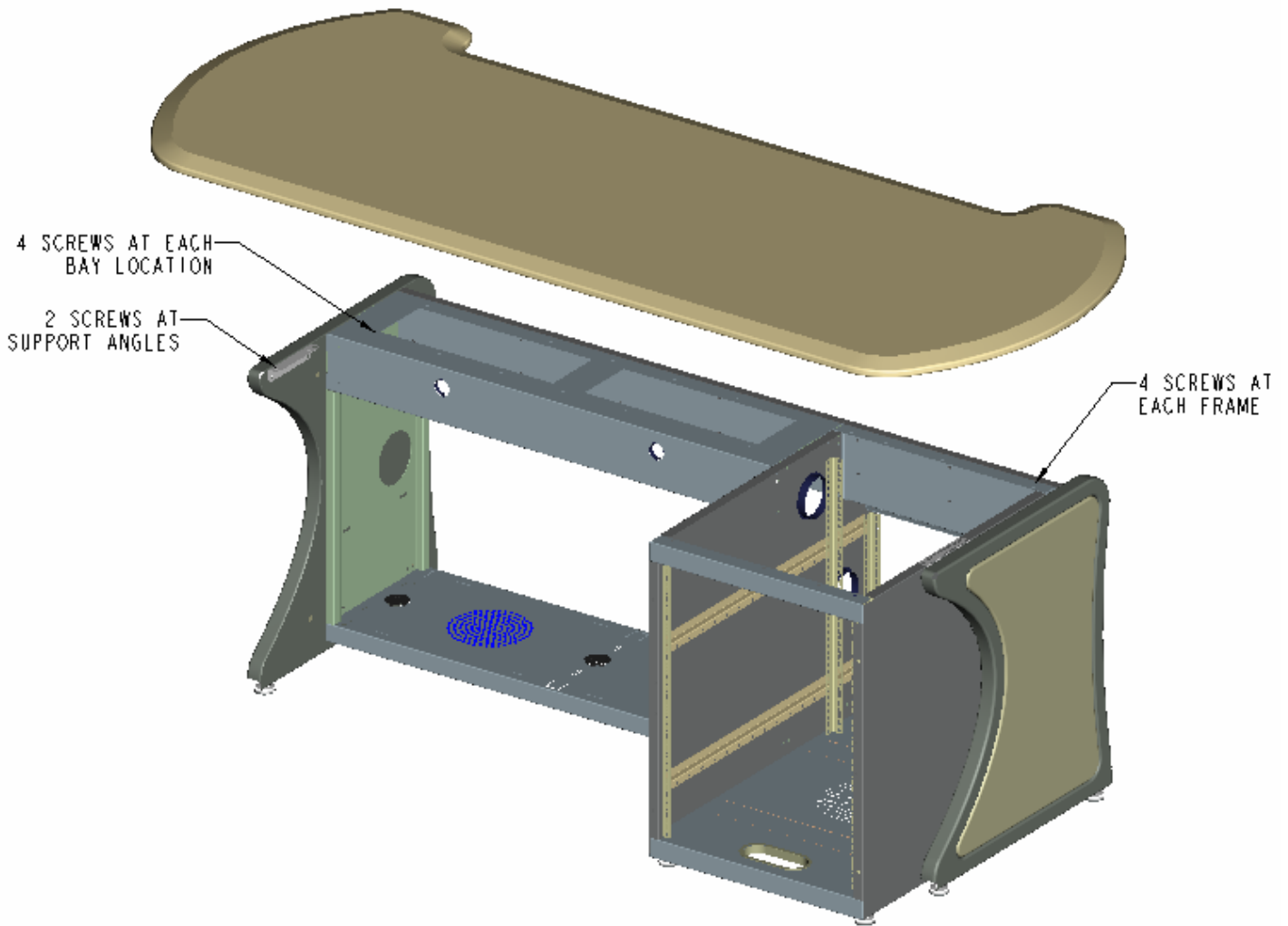

WORK SURFACE ASSEMBLY

- 1) Position work surface on frames. Back edge of work surface should overhang approx. 1/4" (see detail "B"). For straight bay configurations center work surface left to right.
- 2) Secure work surface to frame assembly with wood screws (item 3) as shown. Additional holes have been provided if needed.

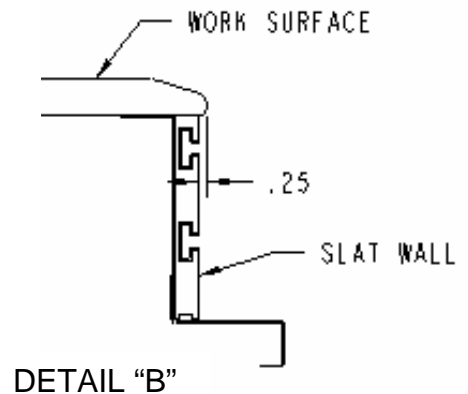

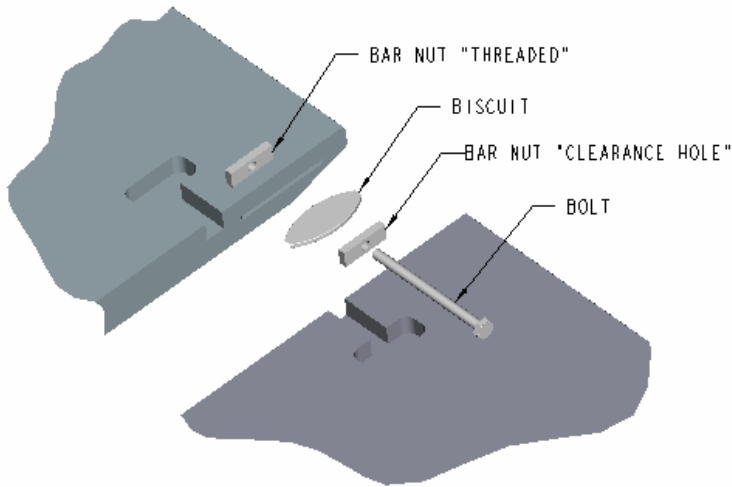

TIGHT JOINT
"EXPLODED"

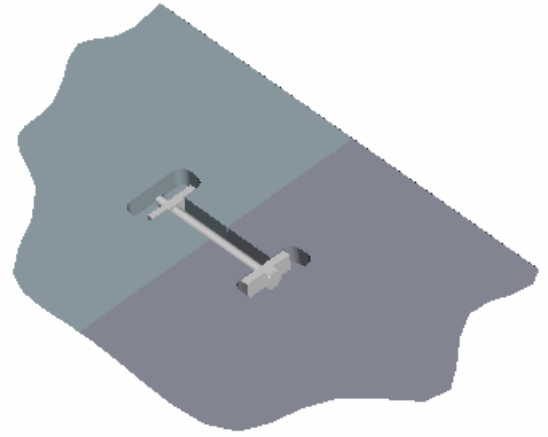

TIGHT JOINT
"ASSEMBLED"

WORK SURFACE TIGHT JOINT ASSEMBLY

- 1) Place work surfaces on top of frames in approximate final position.
- 2) Place one biscuit into each slot location.
- 3) Slide top to expose the tight joint pocket and install bolt and bar nuts.
- 4) Ensure work surfaces are aligned and tighten bolts.

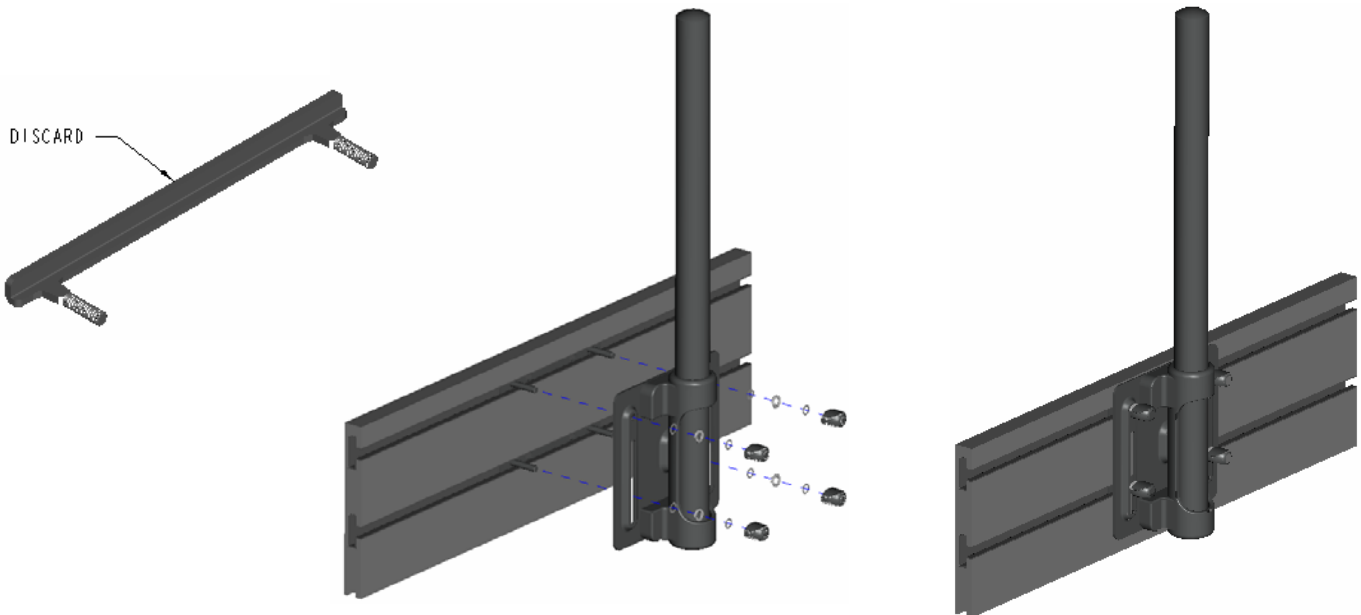

MONITOR ARM MOUNTING:

- 1) Discard mounting angles supplied with pole and use stud plate provided with console. Discard black hex nut and washer that retain nut plate.
- 2) Place pole base over studs.
- 3) Install washers and thumbscrews to secure arm.

FP2 Console Assembly

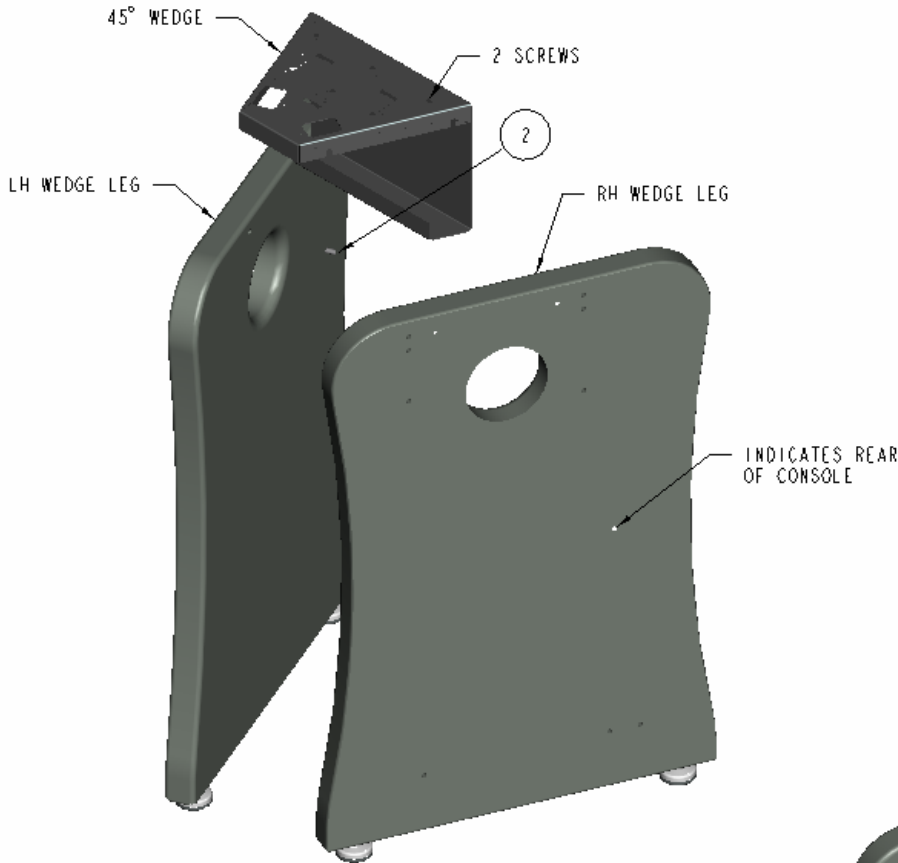

WEDGE ASSEMBLY

- 1) Orientate legs as shown for all wedges. The indicator hole is always positioned to the rear of the console.
- 2) Install qty (2) 1/4-20 button head screws (item 2) into each leg. Leave screws out slightly so the slots in the wedge can drop down over the screws.
- 3) With the wedge in place, tighten the (4) screws.

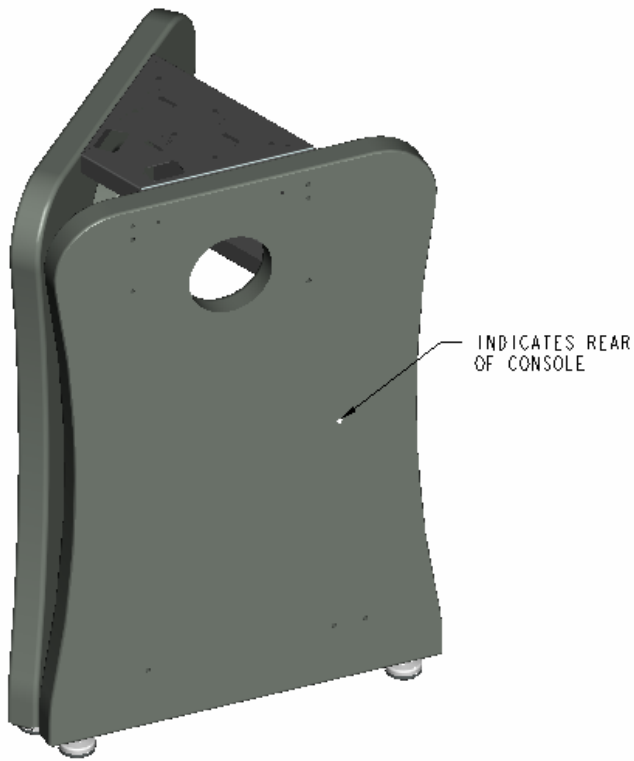

STD 45 DEG WEDGE

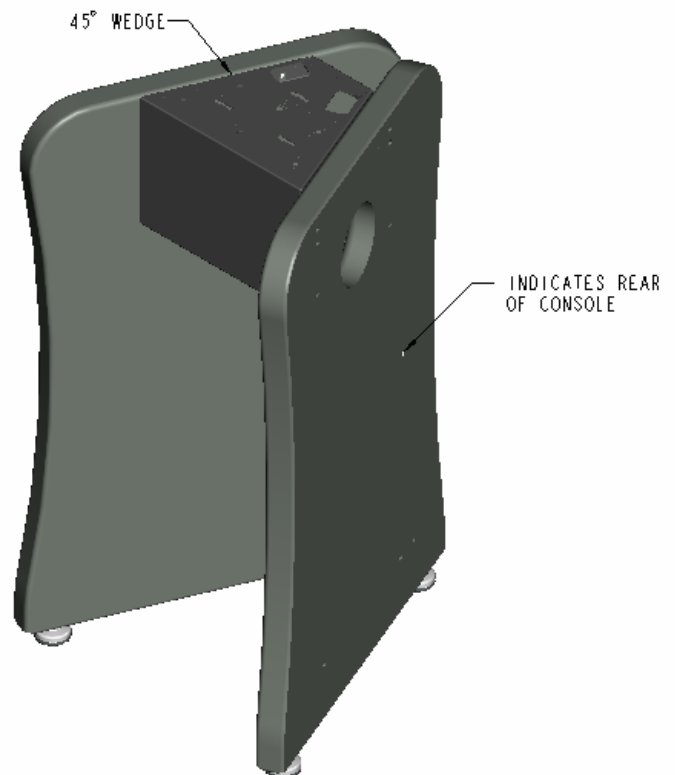

REVERSE 45 DEG WEDGE

Note: Only the wedge is reversed.
Leg orientation remains the same.

FP2 Console Assembly

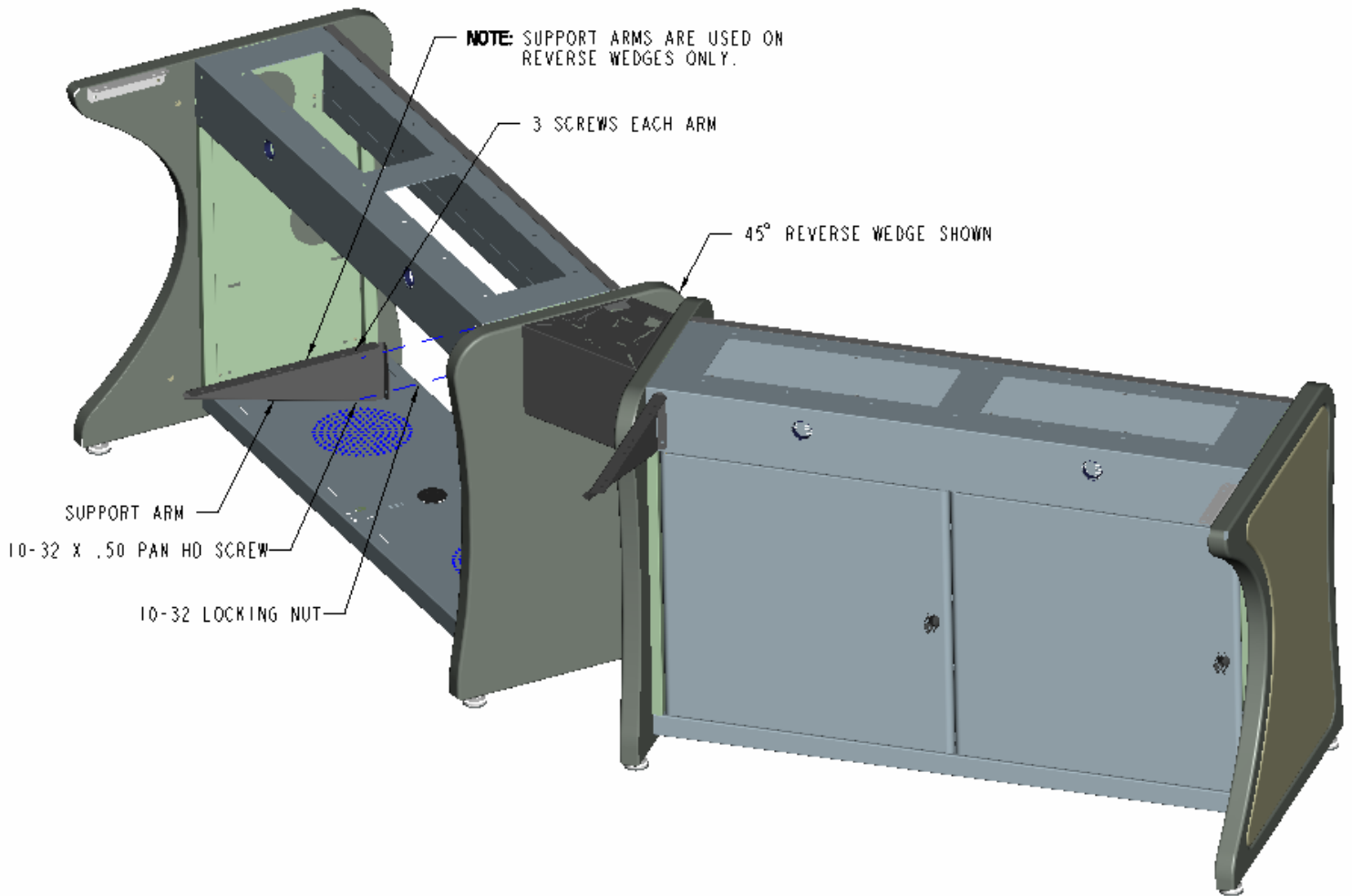

SUPPORT ARM ASSEMBLY:

- 1) Align holes in arm with frame (next to reverse wedge leg) and secure with pan head screw and nut.
- 2) For each arm, install (3) wood screws (item 3) through the arm and into the work surface.